

ALUMA1™
Modular Cleanroom Wall System



ALUMA1 – Cleanroom Wall System – ISO 4 to 8



The ALUMA1 Cleanroom Wall System is a non-progressive, demountable flush system, utilizing all aluminum stud & track components, with Aluminum or Co-Extruded PVC Battens and Coves, suitable for electronics and pharmaceutical applications.

Double-sided walls are 3" thick, and can be used up to 24' high. Single sided walls can utilize a strut style stud for fastening mechanical and electrical components.

Benefits

- ✓ System lays out easily taking into account existing wall and floor abnormalities
- ✓ Electrical and Mechanical components install within wall cavity, as required.
- ✓ No need for exact pre-engineering, all components adaptable on site

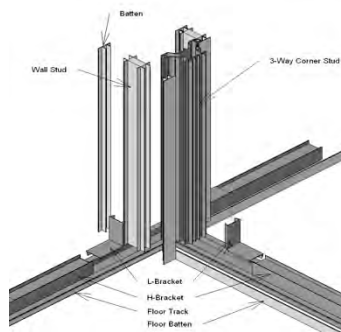
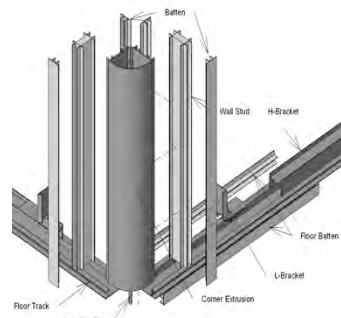

- ✓ Panels can easily be removed to add or modify services.
- ✓ Flush Windows with Tempered Glass or Polycarbonate can be added in any location.

- ✓ Doors and frames can be added at any location along any wall.
- ✓ Wall panel options include: 1/2" ALUMAfoam, 1/4" & 1/2" ALUMA Honeycomb, 1/2" ALUMAfoam with FRP, or 1/2" Vinyl Drywall, all components 4' Wide or cut to suit dimensions as required.
- ✓ Quick Ship, Cleanroom in a Box, components can be shipped while final design is signed off.



- ✓ Room layouts can be changed easily as all of the coves are part of the wall system. Allowing changes, modification, or the addition of future equipment.





Cleanroom Ceiling System



The ALUMA1 Cleanroom Wall System can be installed with any ceiling system, however it works well with the ALUMA-T ceiling grid system.

The ALUMA-T system is a 3" or 6" wide X 4" high extruded Aluminum T with a strut style top, which bolts together to form a system that can be used to run services, or be configured as a walkable ceiling.

Benefits

- ✓ Up to 24' long sections can be used without support from the existing building structure.
- ✓ "Ladder" configuration is precut and can be factory assembled for easy installation on site.
- ✓ Preconfigured for Filtration and Lighting.



- ✓ 6" wide ALUMA-T can be used for mechanical and electrical services, and for flush sprinkler heads.
- ✓ Large panel openings for access to ceiling space.
- ✓ Panels can be ALUMAfoam, ALUMAfoam / FRP or Aluminum Honeycomb.
- ✓ Easily reconfigured to match any changes in wall configurations.
- ✓ Does not have to match a typical 2' X 4' Grid configuration.

All of our Aluminum Components are manufactured using 60% Recycled Aluminum content, 48% Pre Consumer & 12% Post Consumer Content, which may contribute to LEED Credits

Where our extrusions require coating, they are coated with a Powder Coat finish that are a Solvent-Free, Polyester, Hybrid, and Epoxy Powder coat finishes, which Meet or Exceed EPA, AAMA, and ASTM specifications, and are Nonflammable.

Contact Us Toll Free @
1-866-565-7055
vern@e-s-c.com

LEED CREDITS

Indoor Environmental Quality - LEED EQ Credit 4.2 - Low Emitting Materials: Paints and Coatings.



Our products do not require additional field painting, which prevents odorous and irritating air contaminants, adding to the Comfort and well being of workers and building occupants.

122F Commerce Park Drive
Barrie, ON L4N 8W8, Canada